



**BEDROCK**  
HOMES

# ATHENA B

1660 SQ FT  
256 Rolston Wynd



## ROBINSON SHOWHOME

30 Roberts Close, Leduc  
780.980.8506  
robinson@bedrockhomes.ca

Job # ROB -0-034993  
Lot 33, Block 11, Plan TBD

## DETAILS

- Short distance from Park, Pond and Schools
- 3 Bedrooms, 2,5 bathrooms, flex room/ 4th bedroom on the main floor and large central bonus room
- 20x22 Concrete Pad
- Large WIC in Ensuite
- 9' Ceilings on Main Floor
- 6 pc Samsung Stainless Steel Appliances with white high efficiency front load washer/dryer
- 41" Kitchen Upper Cabinets
- Ensuite with double sinks
- Luxury Vinyl plank throughout
- Electric Fireplace in great room
- Quartz throughout
- Smart Home Package
- Upstairs laundry
- Corner Pantry
- LED pot lights throughout
- Triple pane, Low-E argon filled Energy Star rated windows
- Heat recovery ventilator
- Painted organizer with bench and hooks in mudroom
- Pot and Pans drawer
- High efficiency Gas Furnace and 80 gallon electric hot water tank

BUILT TO LAST \ \ **BEDROCKHOMES.CA**

SPEC 2023 - Bedrock Homes Ltd. reserves the right to modify floorplans, renderings, elevations and features in a continuing effort to improve product quality. Floorplans, specifications & prices are subject to change without notice. Errors & omissions exempt.

# ATHENA B

1660 SQ FT  
256 Rolston Wynd



## ROBINSON SHOWHOME

30 Roberts Close, Leduc  
780.980.8506  
robinson@bedrockhomes.ca

Job # ROB -0-034993  
Lot 33, Block 11, Plan TBD



**Main Floor**  
857 SQ FT

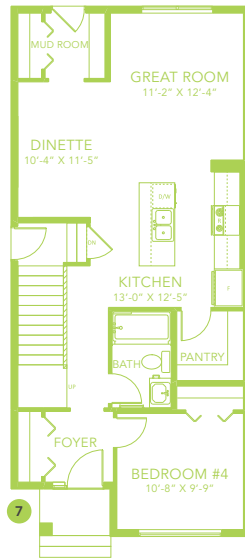

**Second Floor**  
803 SQ FT

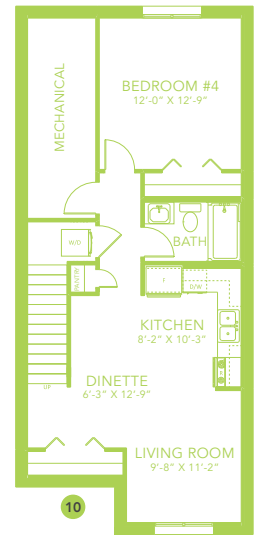

ATHENA B