



BEDROCK
HOMES

PALISADE P

1370 SQ FT
3703 -4th Street



MAPLE CREST SHOWHOME

451 - 37 Avenue NW, Edmonton
587-521-7744
maplecrest@bedrockhomes.ca

Job # MPC-4525
Lot , Block , Plan 192-2185

DETAILS

- This home includes 3 bedrooms, 2.5 bathrooms and an open concept main floor.
- Welcoming great room with bright triple pane windows and a warm linear electric fireplace for friends and family to enjoy. This flows into the dining area, perfect for dinner parties.
- Designer corner kitchen with a flush eating bar, and large pantry with plenty of food storage.
- Clutter-free kitchen with 41" upper cabinets, smooth action metal drawer hardware with soft-close (no slam) mechanisms on all doors and drawers.
- Includes a full stainless steel Samsung Appliance Package.
- A comforting view of your backyard from the kitchen sink
- Primary suite is separated from secondary bedrooms for added privacy. Includes a 3-piece ensuite and a walk-in closet.
- Convenient second floor laundry room and linen closet.
- Kitchen, main floor hallway, foyer, and second floor hallway includes energy saving surface mount LED pot light package.
- High quality luxury vinyl flooring on the main floor, second floor laundry, and bathrooms. Floor is easily maintained as it's water and stain resistant
- 20' x 22' rear concrete parking pad.

PALISADE P

1370 SQ FT
3703 -4th Street



MAPLE CREST SHOWHOME

451 - 37 Avenue NW, Edmonton
587-521-7744
maplecrest@bedrockhomes.ca

Job # MPC-4525
Lot , Block 4, Plan 192-2185

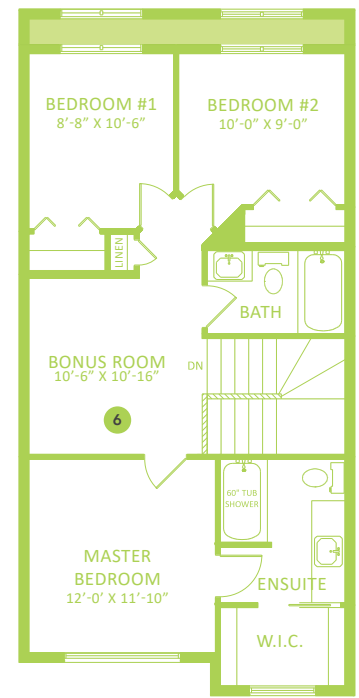
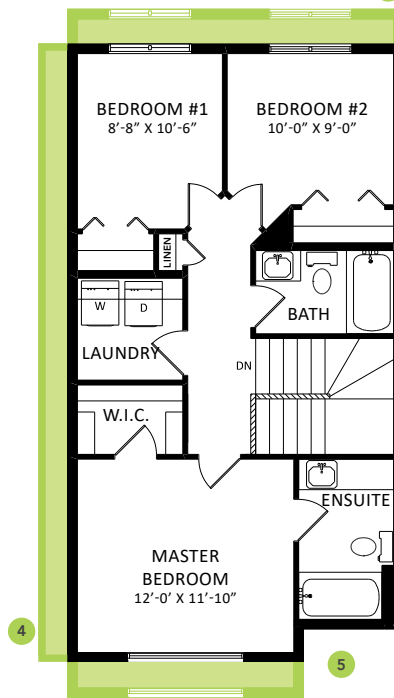
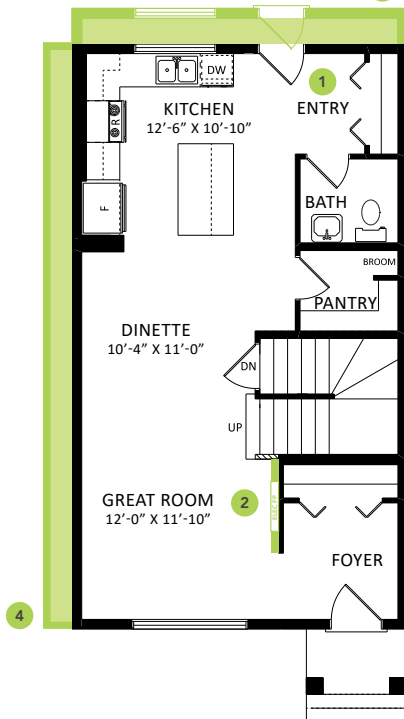

PALISADE P