

The Bailey A

1742 SQ FT

444-42 Ave. NW



- 4 Bedroom, 2.5 bath, bonus room
- Glass panels to garage door
- Metal spindled railing on main floor
- Laminate flooring on main floor
- Tile flooring in all bathrooms, mudroom and laundry
- Cabinets to the ceiling
- Quartz countertops in the kitchen

Maple Crest Showhome

416 - 42 Avenue NW, Edmonton, AB.

587.521.7744

maplecrestsales@bedrockhomes.ca

Job # MPC-0-033972 Lot 126, Block 6, Plan 162-3032

Notes:

bedrockhomes.ca

VISIT US AT ANY OF OUR SHOWHOMES!

Monday - Thursday 3-8pm, Weekends & Holidays 12-5PM



The Bailey A

1742 SQ FT

444-42 Ave. NW



Maple Crest Showhome

416 - 42 Avenue NW, Edmonton, AB.

587.521.7744

maplecrestsales@bedrockhomes.ca

Job # MPC-0-033972 Lot 126, Block 6, Plan 162-3032

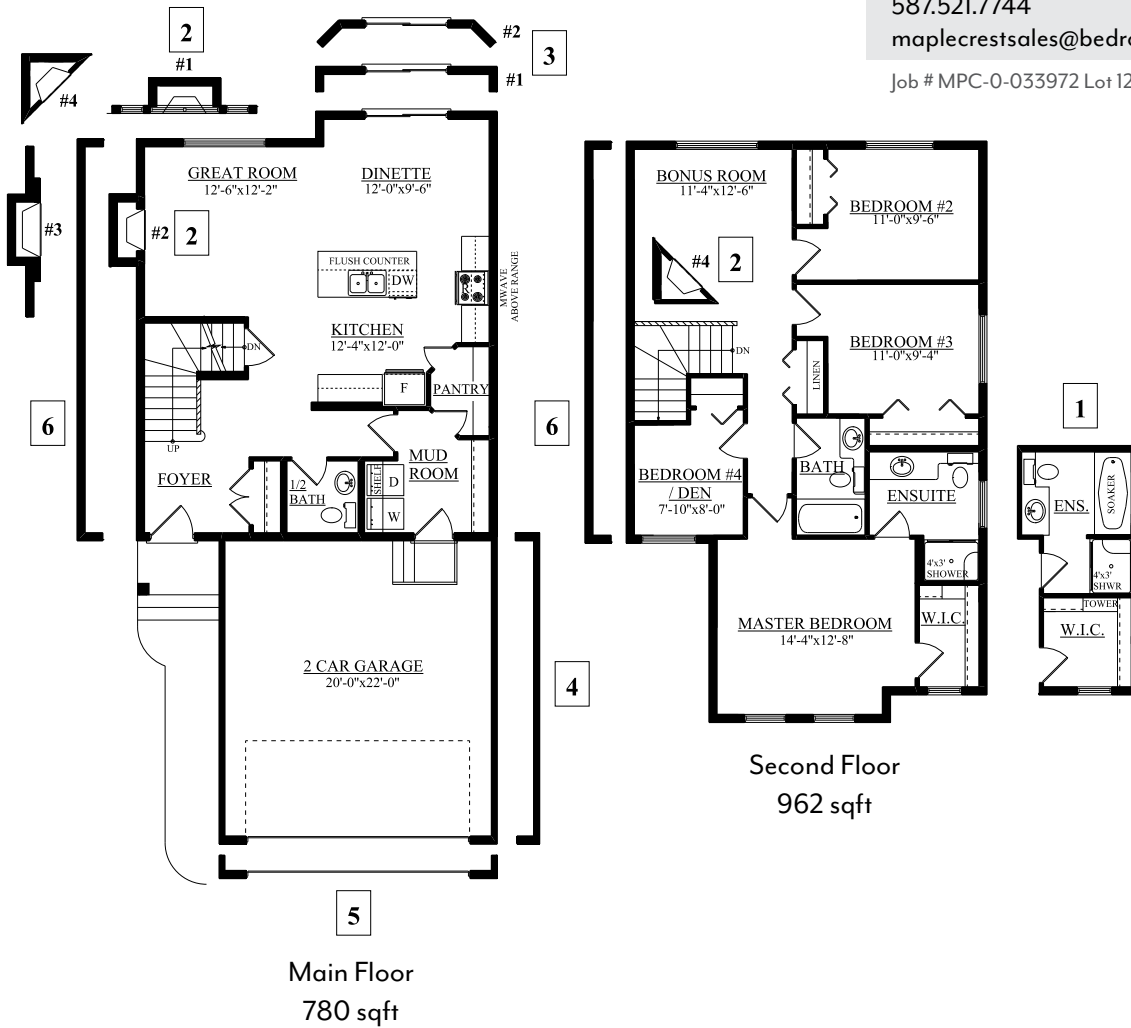

bedrockhomes.ca

VISIT US AT ANY OF OUR SHOWHOMES!

Monday - Thursday 3-8pm, Weekends & Holidays 12-5PM

