

Stella P at 7256 182 Ave NW

BED	BATH	SQ FT	HOME STYLE
4	3	1833	FRONT ATTACHED GARAGE HOME

GARAGE TYPE
DOUBLE ATTACHED

COMMUNITY



QUICK POSSESSION

BLOCK:	1	LOT:	91
STAGE:	1	JOB:	CSA-0-035553

SHOWHOME
ADDRESS
18004 - 70th Street
NW

SHOWHOME
HOURS
Monday - Thursday
from 3 - 8PM
Weekend and
Holidays
from 12 - 5PM

CONTACT



Bruno Ziger 587-570-5471

Model Features

- Main Floor Bedroom & Full Bath: Ideal for guests or multi-generational living.

- Attached Double Car Garage: Provides convenient parking and extra storage space.
- Grand Open-to-Above Staircase: Adds elegance and an airy feel to the main living space.
- Walk-Through Pantry: Conveniently connects the garage to the kitchen for easy grocery unloading.
- Samsung Stainless Steel Appliance Package: Includes a 36" wide fridge with dual ice maker, 30" electric range, smart dishwasher, and microwave hood combo.
- 50" Linear Ortech LED Electric Fireplace: A modern and cozy centerpiece for the living room.
- 9' Basement Foundation Walls: Ready for future basement development or customization.
- Tier 2 Quartz Countertops: High-end finishes in the kitchen and bathrooms for a polished look.
- Second-Floor Laundry Room: Conveniently located near bedrooms for easy access.
- Large Central Bonus Room: Perfect for family relaxation or entertaining.
- Painted Railings with Straight Metal Spindles: Sleek and modern design throughout the staircase.
- Smart Home Package: Includes Alexa Echo Show, Lorex Video Doorbell, Ecobee 3 Lite Thermostat, and Weiser Halo Smart Deadbolt for advanced security and connectivity.
- Backing Onto Green Space: Enjoy privacy and peaceful outdoor views.
- Future Park & K-9 Catholic School Nearby: Perfect for families with children.
- Highway Access with Open Views: Convenient commutes paired with serene surroundings.

Floor Plans

MAIN FLOOR



SECOND FLOOR

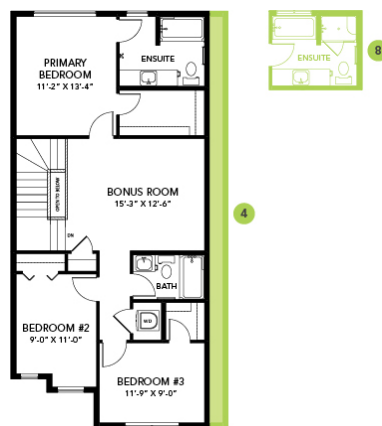

LEGAL BASEMENT SUITE

