

Stella H at 2528 208 Street NW

Get Cash Back

| BED | BATH | SQ FT | HOME STYLE |
|-----|------|-------|----------------------------|
| 4 | 3 | 2031 | FRONT ATTACHED GARAGE HOME |

GARAGE TYPE

DOUBLE ATTACHED



COMMUNITY



SHOWHOME
ADDRESS

Single Family
Home
2504 - 208 Street
NW

SHOWHOME
HOURS

Monday - Thursday
from 3 - 8PM
Weekend and
Holidays
from 12 - 5PM

BLOCK: 1

CONTACT

Mike Marsh
587.906.8970

STAGE: 10B

LOT: 147

JOB: UPL-0-035208

Model Features

- Double front attached garage home with 4 total bedrooms - 3 upstairs and 1 on the main floor with a full bath.
- Complete with a second floor bonus room and second floor laundry.
- Open floorplan in the great room, dining and kitchen area, featuring 9' ceilings and a separate side entry to the 9' basement.
- Durable and stylish luxury vinyl plank flooring on the main floor, bathrooms and laundry room.
- Advanced wear and stain protection carpet with 35oz weight and 8lb underlay on the second floor.
- Modern, contemporary and low maintenance kitchen featuring 41" upper cabinets to the ceilings.
- Complete with a 6-piece appliance package; This includes stainless steel Samsung kitchen appliances and a white front load washer and dryer.
- Upgraded spindle railing on the main and second floor offers optimal lighting and a spacious feel throughout.
- Tuple pane Low E Argon has filled Energy Star rated windows contribute to increased energy efficiency and outside noise reduction.
- 50" Linear electric fire and ice fireplace in the great room with time and colour control.
- Tiled wall shower with acrylic base in the ensuite.
- Modern smart home technology package includes a Smart Home module, Smart thermostat, Smart video doorbell, and Smart front door lock.
- Weather resistant precast concrete exterior steps that require no maintenance, and exterior walls and ceilings are vapour sealed.

Floor Plans

MAIN FLOOR



SECOND FLOOR

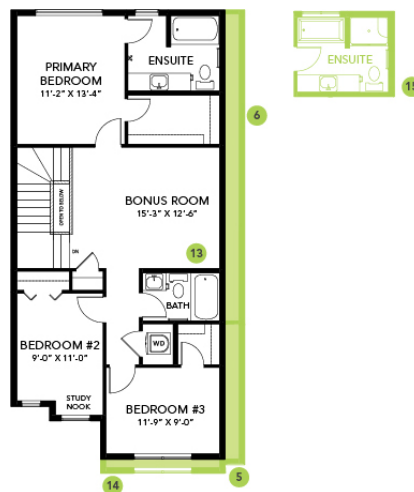

LEGAL BASEMENT SUITE

