

Rylee P at 3297 Kulay Way SW

BED	BATH	SQ FT	HOME STYLE
3	2.5	2025	FRONT ATTACHED GARAGE HOME

GARAGE TYPE

DOUBLE ATTACHED



QUICK POSSESSION

BLOCK: 10 LOT: 94

STAGE: 43 JOB: KWK-0-035389

COMMUNITY



SHOWHOME ADDRESS Single Family Home
3411 Kulay Green SW

SHOWHOME HOURS Monday - Thursday
from 3 - 8PM
Weekend and
Holidays
from 12 - 5PM

CONTACT Craig Watson
587-521-6580

Model Features

- Walking distance to Joey Moss K-9 School and Close access to Joan Carr K-9 Catholic School.
- Every Bedrock Home comes complete with a modern smart home technology system (Smart Home Hub), Ecobee thermostat, video doorbell & Weiser Halo Wi-Fi Smart keyless lock with touch screen.

- This Bedrock home includes a complete appliance package that features: Stainless Steel kitchen appliances including a 28 cu. Ft. French door fridge with bottom pull out freezer and ice machine, a 5 burner range, an OTR microwave and a built-in dishwasher.
- 50" Linear Ortech LED electric fireplace complete with media conduit and power above to mount a TV with no wires visible.
- Spindle railing on the stairs and upper hall to create an open feel from main floor to upper level.
- Huge upstairs bonus room.
- Energy efficient features include Low-E, argon gas filled, Energy Star rated windows, heat recovery ventilator, 96.5% efficient and direct vented furnace, 80gal hot water tank and Bedrock's "Hotbox" system.
- Primary bedroom features a walk-in closet and an ensuite with dual sinks.
- Second floor laundry room.
- Light grey soft close cabinet doors and drawers throughout, and 41' upper cabinets in the kitchen.
- Dark grey quartz countertops with undermount sinks in kitchen and bathrooms.
- Dark grey Luxury Vinyl Plank flooring throughout the main floor, all bathrooms, and the laundry room.
- Dark grey stain-proof carpeting by Mohawk - Portico Collection

Floor Plans

MAIN FLOOR



SECOND FLOOR

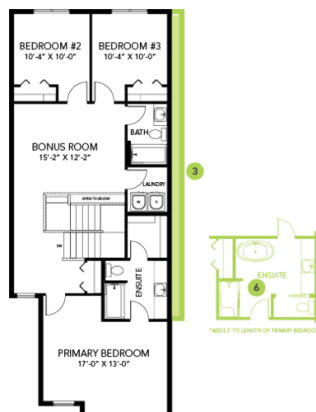

LEGAL BASEMENT SUITE

