

# Maeve F at 17427 2 Street NW

BED      BATH      SQ FT      HOME STYLE  
3+      2.5      2328      FRONT ATTACHED GARAGE HOME

GARAGE TYPE  
DOUBLE ATTACHED



COMMUNITY



SHOWHOME ADDRESS

Single Family Home with Front Attached Garage  
17215 2 Street NW

SHOWHOME HOURS

Monday - Thursday  
from 3 - 8PM  
Weekend and  
Holidays  
from 12 - 5PM

BLOCK:                      1

STAGE:                     1B

LOT:                         35

JOB:                         MAR-0-035473

CONTACT

Daria Zaytseva  
587.705.0522

# Model Features

- Marquis West is away from the hustle and bustle, yet close to Edmonton's main ring road for quick access to amenities and an easy commute.
- This beautiful open concept home has a 9' main floor with a spacious flex room located just off the foyer.
- The great room features a sleek 50" linear fireplace that creates a nice ambience in the room.
- You will enjoy the convenience of the walk-through pantry which leads into the kitchen.
- The kitchen is perfect for entertaining, and features quartz counters with extensive cabinet space and a large island.
- The kitchen includes a 4-piece Samsung appliance package.
- A side entrance is included for a potential Legal Suite, with the basement ceiling height upgraded to 9' for a more spacious feel.
- Metal spindle railing on the main and second floor.
- Upstairs you will find 3 bedrooms and a large central bonus room.
- The primary suite is private and spacious, and you will love the spa-like ensuite which includes double sinks, a free-standing soaker tub and a tiled shower.
- Bedrock Homes are smart! Enjoy controlling your thermostat, video doorbell, front door lock and much more with our included Smart Home System.
- Durable and stylish luxury vinyl plank flooring on the main floor, bathrooms and laundry room.
- Advanced stain and wear protection carpet with 35oz weight and 8lb. underlay on the second floor.
- No neighbors behind.

## Floor Plans

MAIN FLOOR

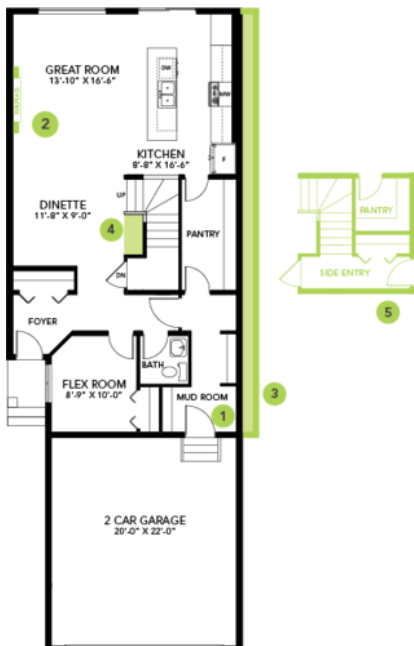

SECOND FLOOR

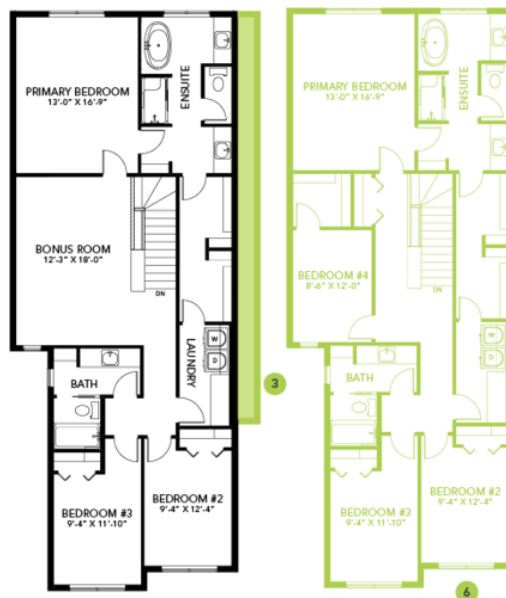

LEGAL BASEMENT SUITE

