

Stella B at 49 Ashbury Crescent

BED	BATH	SQ FT	HOME STYLE	GARAGE TYPE
3	2.5+	1833	FRONT ATTACHED GARAGE HOME	DOUBLE ATTACHED



AVAILABLE

BLOCK: 31 LOT: 25

STAGE: 12 JOB: JSP-0-035493

COMMUNITY



SHOWHOME ADDRESS

3 Ashbury Crescent

SHOWHOME HOURS

Monday - Thursday
from 3 - 8PM

Weekend and
Holidays
from 12 - 5PM

CONTACT

Daria Zaytseva
587.802.1334

Model Features

- Pie-Shaped lot; Steps from Park and running trails.
- Side Entry
- Den/Office on the main floor; 3 Bedrooms, 2.5 bathrooms and central bonus room upstairs
- 18 x 20 Attached Double car Garage

- Walkthrough Pantry and Mudroom
- 9' Ceilings on Main Floor
- 6 pc Samsung Stainless Steel Appliances with white high efficiency front load washer/dryer
- Upgraded Kitchen Backsplash
- Upgraded shower with tiled walls and 10 Mil Glass Barn Door; dual sinks.
- 9' foundation walls
- Upgraded Siding to a Premium Color
- Electric Fireplace in great room Paint Grade Railing with Straight Metal Spindles Luxury Vinyl plank throughout
- Quartz throughout
- Smart Home Package
- Upstairs laundry
- Upgraded Overhead Garage Door
- 41" Kitchen Upper Cabinets
- LED pot lights throughout
- Triple pane, Low-E argon filled Energy Star rated windows.
- Heat recovery ventilator

Floor Plans

MAIN FLOOR



SECOND FLOOR

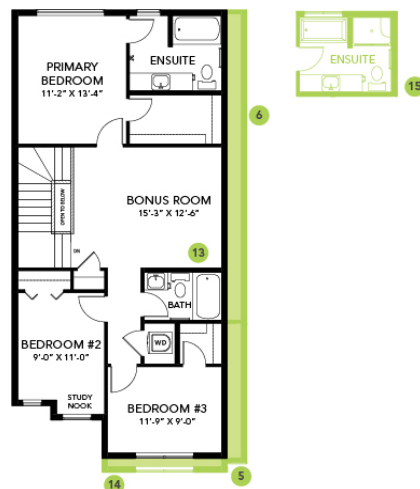

LEGAL BASEMENT SUITE

