

Rylee H at 31 Ashbury Crescent

BED	BATH	SQ FT	HOME STYLE
3	2.5	1989	FRONT ATTACHED GARAGE HOME

GARAGE TYPE
DOUBLE ATTACHED

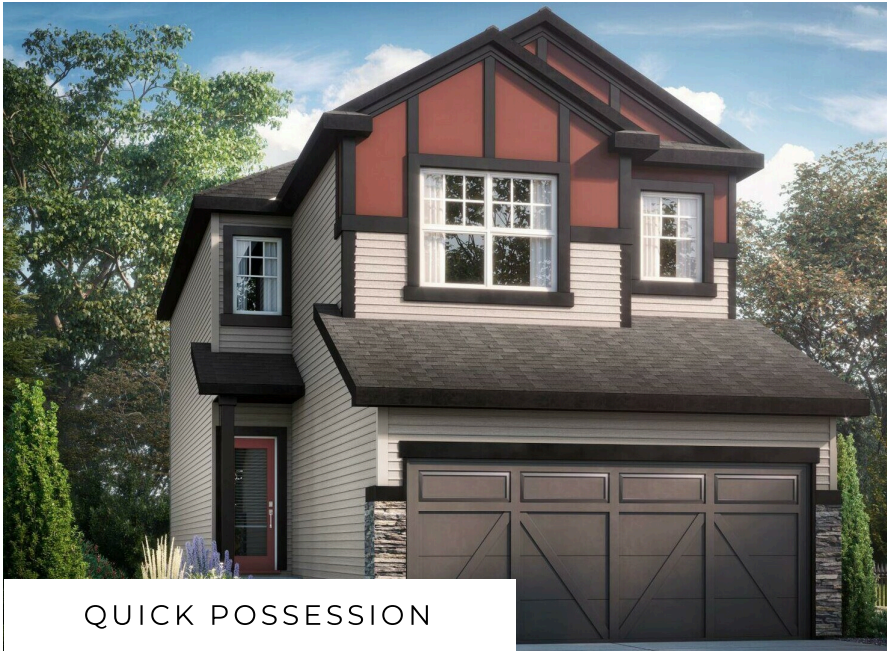

QUICK POSSESSION

BLOCK:	31	LOT:	16
STAGE:	12	JOB:	JSP-0-035492

COMMUNITY

Jesperdale
in ASPEN GLEN

SHOWHOME ADDRESS

3 Ashbury Crescent

SHOWHOME HOURS

Monday - Thursday
from 3 - 8PM
Weekend and
Holidays
from 12 - 5PM

CONTACT

Mike Marsh
587.802.1334

Model Features

- Steps from Park and running trails
- Grand open to above central staircase
- 3 Bedrooms, 2.5 bathrooms and bonus room upstairs

- 18 x 22 Attached Double Car Garage
- Walkthrough Pantry and Mudroom
- 9' Ceilings on Main floor and 9' Foundation walls
- 6-piece Samsung Stainless Steel Appliances with white high efficiency front load washer/dryer
- Upgraded Kitchen Backsplash
- Dual sinks in ensuite
- Side Entry
- Upgraded Siding to a premium colour
- Electric Fireplace in great room
- Paint Grade Railing with straight metal spindles
- Luxury Vinyl plank throughout
- Quartz throughout
- Smart Home package
- Upstairs laundry
- Upgraded overhead garage door
- 41" Kitchen upper cabinets
- LED pot lights throughout
- Triple pane, Low-E argon filled Energy Star rated windows
- Heat recovery ventilator

Floor Plans

MAIN FLOOR



SECOND FLOOR

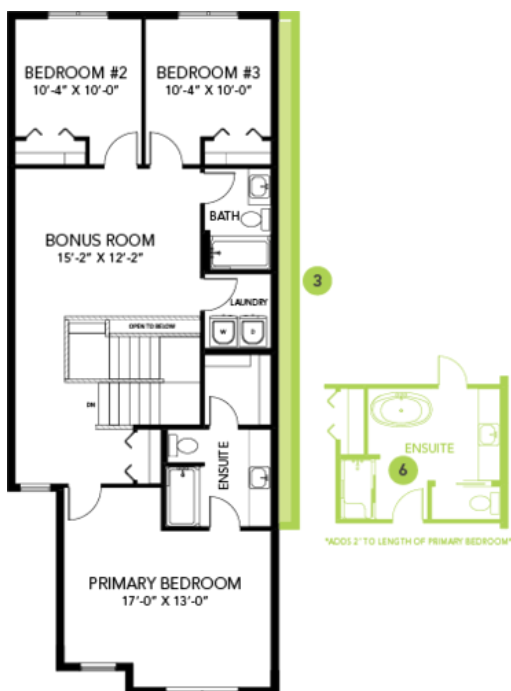

LEGAL BASEMENT SUITE

