

# Ruby P at 29 Ashbury Crescent

BED	BATH	SQ FT	HOME STYLE
3	2.5	1928	FRONT ATTACHED GARAGE HOME

GARAGE TYPE

DOUBLE ATTACHED



QUICK POSSESSION

BLOCK:	31	LOT:	15
STAGE:	12	JOB:	JSP-0-035491

COMMUNITY

**Jesperdale**  
in ASPEN GLEN

SHOWHOME  
ADDRESS

3 Ashbury Crescent

SHOWHOME  
HOURS

Monday - Thursday  
from 3 - 8PM  
Weekend and  
Holidays  
from 12 - 5PM

CONTACT

Mike Marsh  
587.802.1334

## Model Features

- Steps from parks and running trails
- Direct access to laundry room from the primary bedroom
- 3 Bedrooms, 2.5 bathrooms and bonus room upstairs

- 18 x 22 Attached double car garage
- Corner kitchen with large square island
- 9' Ceilings on Main and 9' Foundation walls
- 6-piece Samsung Stainless Steel Appliances with white high efficiency front load washer/dryer
- Upgraded Kitchen Backsplash
- Dual sinks in ensuite
- Side entry
- Upgraded siding to a premium colour
- Electric fireplace in the great room
- Paint Grade Railing with straight metal spindles
- Luxury vinyl plank throughout
- Quartz throughout
- Smart Home package
- Upstairs laundry
- Upgraded overhead garage door
- 41" Kitchen upper cabinets
- LED pot lights throughout
- Triple pane, Low-E argon filled Energy Star rated windows
- Heat recovery ventilator

## Floor Plans

MAIN FLOOR



SECOND FLOOR

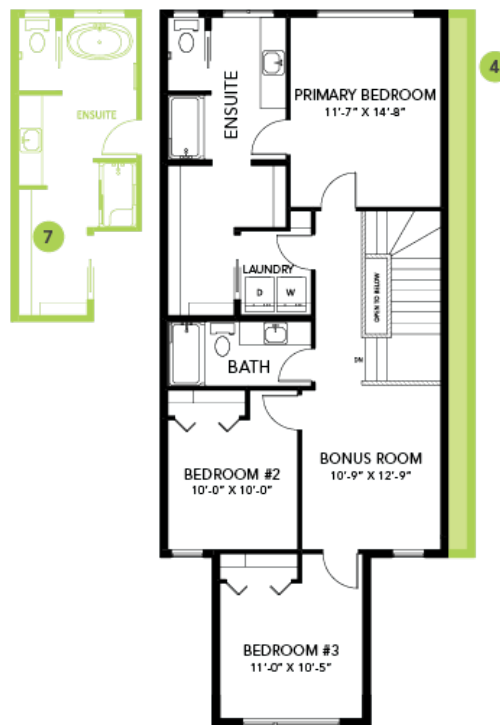

LEGAL BASEMENT SUITE

