

Amari F at 2603 5 Ave SW

BED BATH SQ FT HOME STYLE
3+ 2.5 1997 FRONT ATTACHED GARAGE HOME

GARAGE TYPE
DOUBLE ATTACHED

COMMUNITY



AVAILABLE JUL. 2025

SHOWHOME ADDRESS Single Family Home
303-29 St SW

SHOWHOME HOURS Monday - Thursday
from 3 - 8PM
Fridays: By Appointment
Weekend and Holidays
from 12 - 5PM

CONTACT



Doug Jensen
587.805.2131

BLOCK: 10

STAGE: 5

LOT: 127

JOB: ALC-0-036022

Model Features

The Amari seamlessly blends form and function, making it an ideal place to call home. Just off the open-to-above foyer, you're greeted by a half bathroom and flex room. The main floor opens up to reveal a central kitchen, and a dinette and great room at the rear of the home. Convenience is plentiful thanks to the walk-through pantry and mudroom just off the double car garage. Upstairs, you'll find a large central bonus room, laundry room, two secondary bedrooms, full bathroom, and a primary bedroom with a roomy ensuite and walk-in closet.

- Optional: Side entry
- Optional: Main floor bedroom
- Optional: Basement suite
- Optional: 4-piece ensuite
- Optional: Fireplace

Floor Plans

MAIN FLOOR

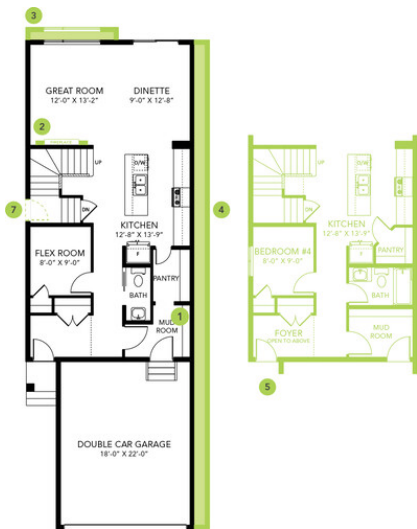

SECOND FLOOR

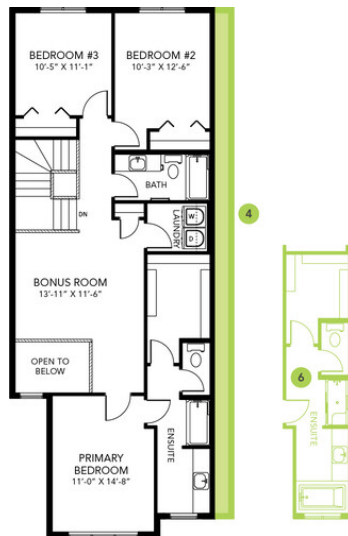

LEGAL BASEMENT SUITE

