



**BEDROCK**  
HOMES

# STELLA K

1833 SQ FT  
3269 Kulay Way SW



## ONE AT KESWICK SHOWHOME

3411 Kulay Green SW, Edmonton

587-521-6580

[oneatkeswick@bedrockhomes.ca](mailto:oneatkeswick@bedrockhomes.ca)

Job # KWK 0-035062  
Lot 84, Block 10, Plan 212-2788

## DETAILS

- 9 ft. ceilings on the main floor
- Spindle railing on main and second floor creating an open staircase top to bottom
- 4 pc. Ensuite with a stand-up shower
- Bonus room upstairs
- Main floor Den added
- Side Entrance for suite possibility
- Splatter texture ceiling (as opposed to popcorn texture)
- White cabinets throughout (KitchenCraft Soho Thermofoil Satin White), finished to the ceiling in the kitchen, with contrasting black pulls with soft close action
- Grey quartz countertops in kitchen and upstairs bathrooms with undermount sinks (Sudbury)
- Luxury vinyl plank flooring throughout main floor and wet areas (Divine Quest North Face)
- Stain-proof carpeting upstairs (Effortless Choice)
- 6 pc. Stainless Steel appliances with white high efficiency front load washer/dryer
- Triple pane, low-E argon filled Energy Star rated windows
- Heat recovery ventilator, high efficiency gas furnace and 80 gallon electric hot water tank

BUILT TO LAST \ \ **BEDROCKHOMES.CA**

SPEC 2022 - Bedrock Homes Ltd. reserves the right to modify floorplans, renderings, elevations and features in a continuing effort to improve product quality. Floorplans, specifications & prices are subject to change without notice. Errors & omissions exempt.



**BEDROCK**  
HOMES

# STELLA K

1833 SQ FT  
3269 Kulay Way SW



## ONE AT KESWICK SHOWHOME

3411 Kulay Green SW, Edmonton

587-521-6580

oneatkeswick@bedrockhomes.ca

Job # KWK 0-035062

Lot 84, Block 10, Plan 212-2788

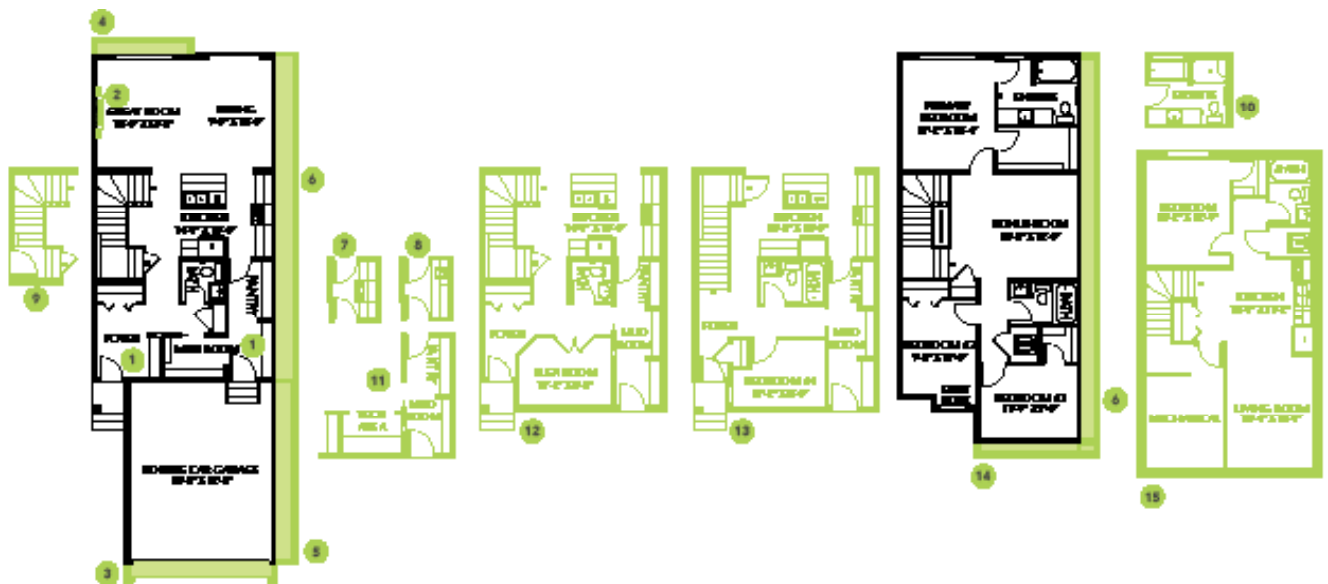

Main Floor  
921 SQ FT

Second Floor  
912 SQ FT

BUILT TO LAST \ BEDROCKHOMES.CA

SPEC 2022 - Bedrock Homes Ltd. reserves the right to modify floorplans, renderings, elevations and features in a continuing effort to improve product quality. Floorplans, specifications & prices are subject to change without notice. Errors & omissions exempt.