



ONE AT KESWICK SHOWHOME

2745 Koshal Place SW, Edmonton
587-521-6580
oneatkeswick@bedrockhomes.ca

Job # KWK 0-035028
Lot 6, Block 22, Plan 212-1825

DETAILS

- 1 block away from Joey Moss K-9 Public School Opening Fall 2022
- Side entrance for future legal suite
- Flex room on main floor
- Brilliant Home Technology (includes built-in control panel, video doorbell, smart Ecobee thermostat, programmable LED potlights lights, keyless entry, built-in Alexa capability, and access to the Brilliant Home app)
- 9 ft. ceilings on the main floor
- LED pot lights throughout
- Electric fireplace in living room
- Spindle railing on main floor
- Splatter texture ceiling (as opposed to popcorn texture)
- 3 pc. Ensuite with fiberglass stand-up shower
- Large 9' kitchen island with flush eating bar
- Grey cabinets throughout (KitchenCraft Soho Thermofoil
- Satin Sleet), finished to the ceiling in the kitchen, with contrasting black pulls
- Grey quartz countertops in kitchen and upstairs bathrooms with undermount sinks (Flint)
- Luxury vinyl plank flooring throughout main floor and wet areas (Divine Quest Into the Wild)
- Stain-proof carpeting upstairs (True Harmony Eclipse)
- 6 pc. Stainless Steel appliances with white high efficiency front load washer/dryer
- Triple pane, low-E argon filled Energy Star rated windows
- Heat recovery ventilator, high efficiency gas furnace and 80 gallon electric hot water tank
- 20x22 garage pad



ONE AT KESWICK SHOWHOME

2745 Koshal Place SW, Edmonton
587-521-6580
oneatkeswick@bedrockhomes.ca

Job # KWK 0-035028
Lot 6, Block 22, Plan 212-1825

3

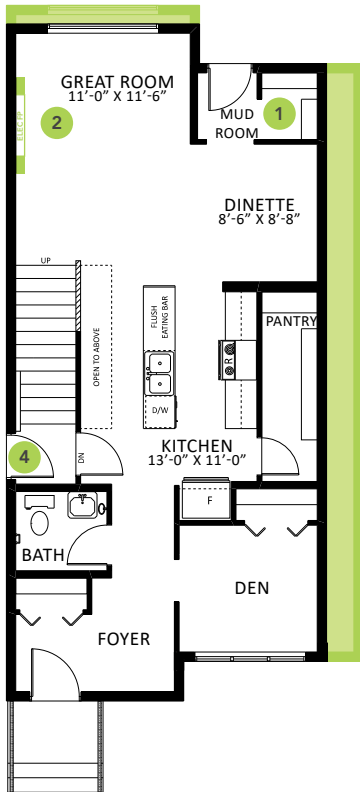

Main Floor
808 SQ FT

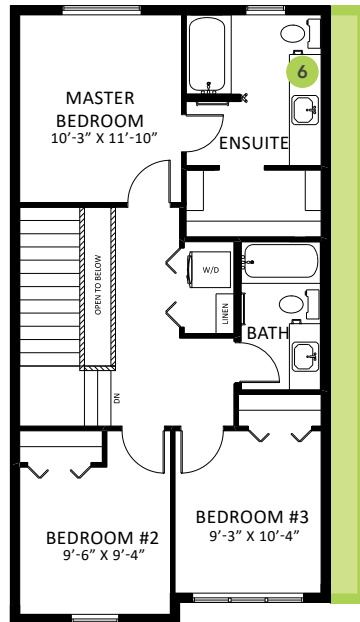

Second Floor
685 SQ FT

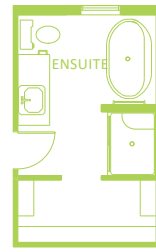

7

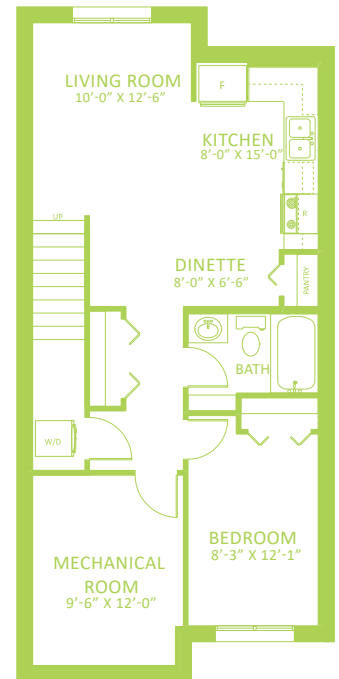

8

DAYA K