

PALISADE P

1370 SQ FT
2367 Kelly Circle SW



ONE AT KESWICK SHOWHOME

2113 Koshal Way SW, Edmonton
587.521.6580
oneatkeswick@bedrockhomes.ca

Job # KWK-0-034502
Lot 42, Block 13, Plan 182-3259

Over
\$19,000
in Designer
Upgrades

DETAILS

- 3 bedrooms, 2.5 baths
- Second floor laundry
- 9' ceilings on main floor
- Upgrade to splatter texture on ceilings throughout
- Kitchen Craft Woodgrain Chillagoe cabinets with 41" upgraded upper cabinets
- Hanstone Fusion quartz countertops with undermount sinks
- Linear electric fireplace
- 5 Samsung stainless steel appliances
- Luxury vinyl plank floors in Divine Quest Endless Summer
- Triple pane low E Argon filled Energy Star rated windows
- Heat recovery ventilator, high efficiency furnace and hot water tank



BEDROCK
HOMES

PALISADE P

1370 SQ FT
2367 Kelly Circle SW



ONE AT KESWICK SHOWHOME

2113 Koshal Way SW, Edmonton
587.521.6580

oneatkeswick@bedrockhomes.ca

Job # KWK-0-034502
Lot 42, Block 13, Plan 182-3259

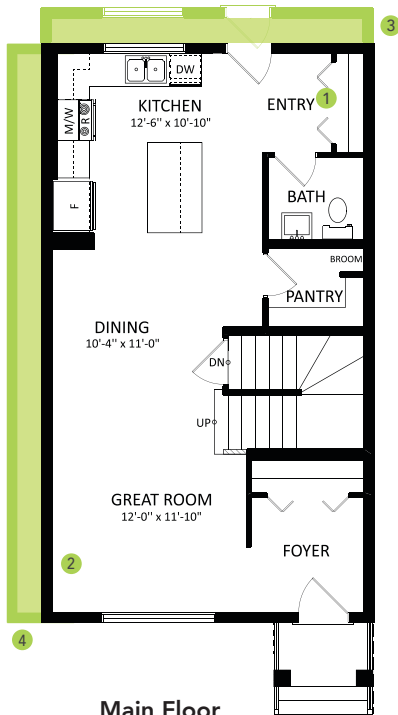

Main Floor
700 SQ FT

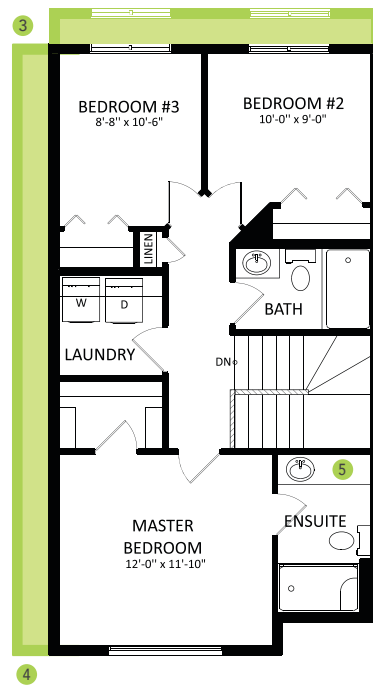

Second Floor
670 SQ FT