



BEDROCK
HOMES

ELENA B

2088 SQ FT
5327 Lark Landing



KINGLET SHOWHOME

5708 Lark Point NW, Edmonton
825-512-1050
kinglet@bedrockhomes.ca

Job # KNG-035298
Lot 47, Block 3, Plan 222-0235

DETAILS

- This stunning single family features a WALKOUT BASEMENT, 2088 sq. ft., 3 Bedrooms, 2.5 bathroom, spacious second floor bonus room, convenient walk through pantry and more!
- Do you love to host gatherings with friends and family? The layout in this home is an entertainers dream!
- Ample countertop space complete with quartz. The walk through pantry offers tons of storage space and is complete with a sleek frosted pantry door.
- Stunning 41" upper kitchen cabinets provide you with stunning visual appeal and more room for dishes and small appliances!
- Enjoy sitting back in your great room that boasts a linear electric fireplace - use the handy remote to change the flame colors to fit the mood.
- Enjoy the open airy concept with railing on both the main and continued upstairs on the second floor.
- Sit back on your rear deck located just off the dining room. Perfect for summer BBQ's!
- This amazing home is situated on a huge pie shaped lot, waiting for you and your family!
- HRV providing a continuous air flow throughout entire home to not only exhaust stale, humid air and odours from home but also reduce condensation, mold, mildew, etc.
- Triple pane low E argon filled energy star rated windows; contributing to cost and energy efficiency.
- No appliance shopping needed! Bedrock sets you up with all the appliances you need including front load washer and dryer.
- Soaring 9'4" foundation walls, huge windows and a patio sliding door completes the walkout basement.

BUILT TO LAST \ \ **BEDROCKHOMES.CA**

SPEC 2022 - Bedrock Homes Ltd. reserves the right to modify floorplans, renderings, elevations and features in a continuing effort to improve product quality. Floorplans, specifications & prices are subject to change without notice. Errors & omissions exempt.



BEDROCK
HOMES

ELENA B

2088 SQ FT
5327 Lark Landing



KINGLET SHOWHOME

5708 Lark Point NW, Edmonton
825-512-1050
kinglet@bedrockhomes.ca

Job # KNG-035298
Lot 47, Block 3, Plan 222-0235

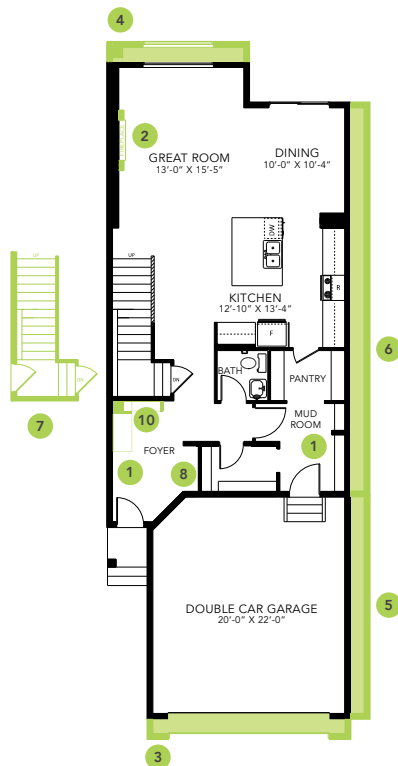

Main Floor
1011 SQ FT

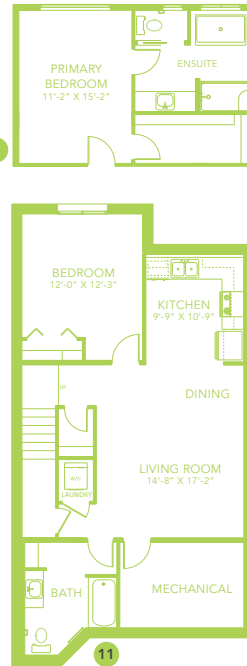
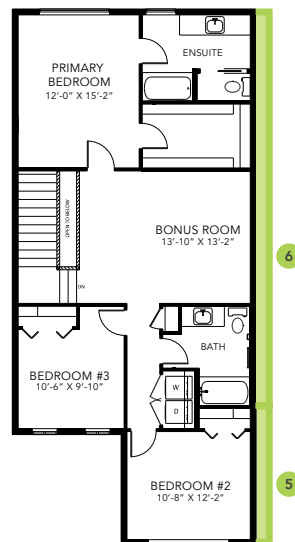

Second Floor
1077 SQ FT

BUILT TO LAST \ BEDROCKHOMES.CA

SPEC 2022 - Bedrock Homes Ltd. reserves the right to modify floorplans, renderings, elevations and features in a continuing effort to improve product quality. Floorplans, specifications & prices are subject to change without notice. Errors & omissions exempt.