



BEDROCK
HOMES

STELLA P

1833 SQ FT
5359 Lark Landing



KINGLET SHOWHOME

5708 Lark Point NW, Edmonton
825-512-1050
kinglet@bedrockhomes.ca

Job # KNG-035285
Lot 63, Block 3, Plan 222-0235

DETAILS

- This home has it all! 4 bedrooms, 3 full bathrooms, spacious walk through pantry, cozy bonus room and more!
- Utilize the main floor bedroom as an office, play room, suite, or craft space! The upgraded bathroom features a shower and vanity.
- Convenient walk through pantry with tons of storage space for Costco trips and small appliances.
- Beautiful 41" upper cabinets complete with a bulkhead so that you no longer have to dust! This feature also adds storage space.
- Open spindle railing from the main floor up to the second floor adds an airy feel and natural light.
- No appliance shopping required! This home features stunning stainless steel kitchen appliances and a white front load washer and dryer!
- Handy laundry space on the second floor - no more hauling clothes up two flights of stairs!
- HRV providing a continuous air flow throughout entire home to not only exhaust stale, humid air and odours from home but also reduce condensation, mold, mildew, etc.
- Triple pane low E argon filled energy star rated windows; contributing to cost and energy efficiency.

BUILT TO LAST \ \ **BEDROCKHOMES.CA**

SPEC 2022 - Bedrock Homes Ltd. reserves the right to modify floorplans, renderings, elevations and features in a continuing effort to improve product quality. Floorplans, specifications & prices are subject to change without notice. Errors & omissions exempt.



BEDROCK
HOMES

STELLA P

1833 SQ FT
5359 Lark Landing



KINGLET SHOWHOME

5708 Lark Point NW, Edmonton
825-512-1050
kinglet@bedrockhomes.ca

Job # KNG-035285
Lot 63, Block 3, Plan 222-0235

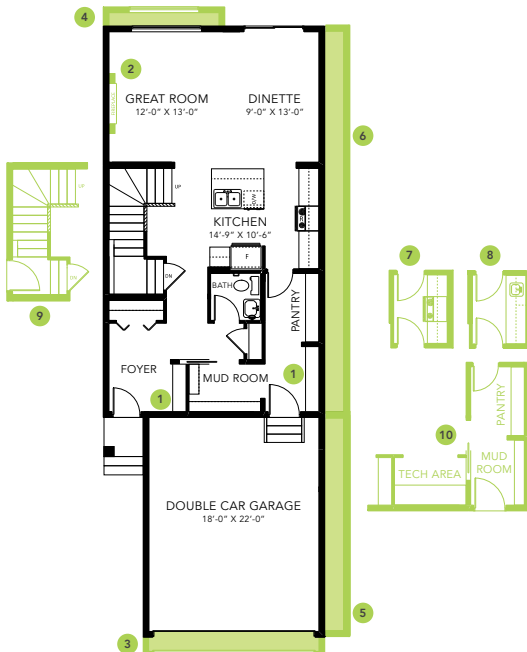

Main Floor
921 SQ FT

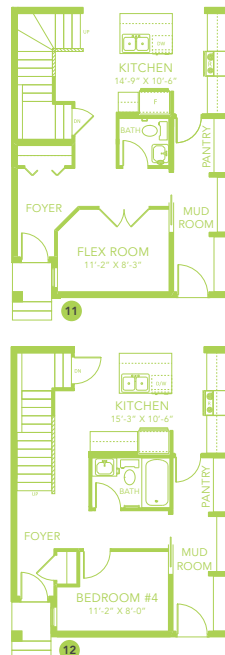

Second Floor
912 SQ FT

