



**BEDROCK**  
HOMES

# STELLA K

1770 SQ FT  
TBD



## KINGLET SHOWHOME

5708 Lark Point NW, Edmonton

825-512-1050

kinglet@bedrockhomes.ca

Job # KNG-035080  
Lot 76, Block 3, Plan TBD

## DETAILS

- Additional value of upgrades \$49,055
- Don't let the size fool you! This 3 bedroom, 2.5 bath home features a walkout basement and is huge in personality!
- Double front attached garage perfect for the cold winters.
- Drop your groceries off in the huge walk through pantry on your way in to your kitchen.
- If you like to entertain then this kitchen is your dream! Your spacious 5' x 4' Island faces your dining room and great room so you always feel included in the party!
- In your kitchen you will find your four stainless steel appliances, including a front load washer and dryer waiting in your new laundry room.
- The Primary suite gives you that retreat feel with your own ensuite 2 sinks and walk in closet!
- Open spindle railings on the first and second floor providing a sleek visual appeal and design.
- Brilliant Smart Home - What does it do? Almost everything! Ask it to control the Ecobee Thermostat, Lock the door using a smart lock and more!
- Triple pane low E argon filled energy star rated windows; contributing to cost and energy efficiency
- HRV providing a continuous air flow throughout entire home to not only exhaust stale, humid air and odours from home but also reduce condensation, mold, mildew, etc.
- 9' ceilings on the main floor and walkout basement open up your space.

BUILT TO LAST \ BEDROCKHOMES.CA

SPEC 2022 - Bedrock Homes Ltd. reserves the right to modify floorplans, renderings, elevations and features in a continuing effort to improve product quality. Floorplans, specifications & prices are subject to change without notice. Errors & omissions exempt.



**BEDROCK**  
HOMES

# STELLA K

1770 SQ FT  
TBD



## KINGLET SHOWHOME

5708 Lark Point NW, Edmonton

825-512-1050

kinglet@bedrockhomes.ca

Job # KNG-035080

Lot 76, Block 3, Plan TBD

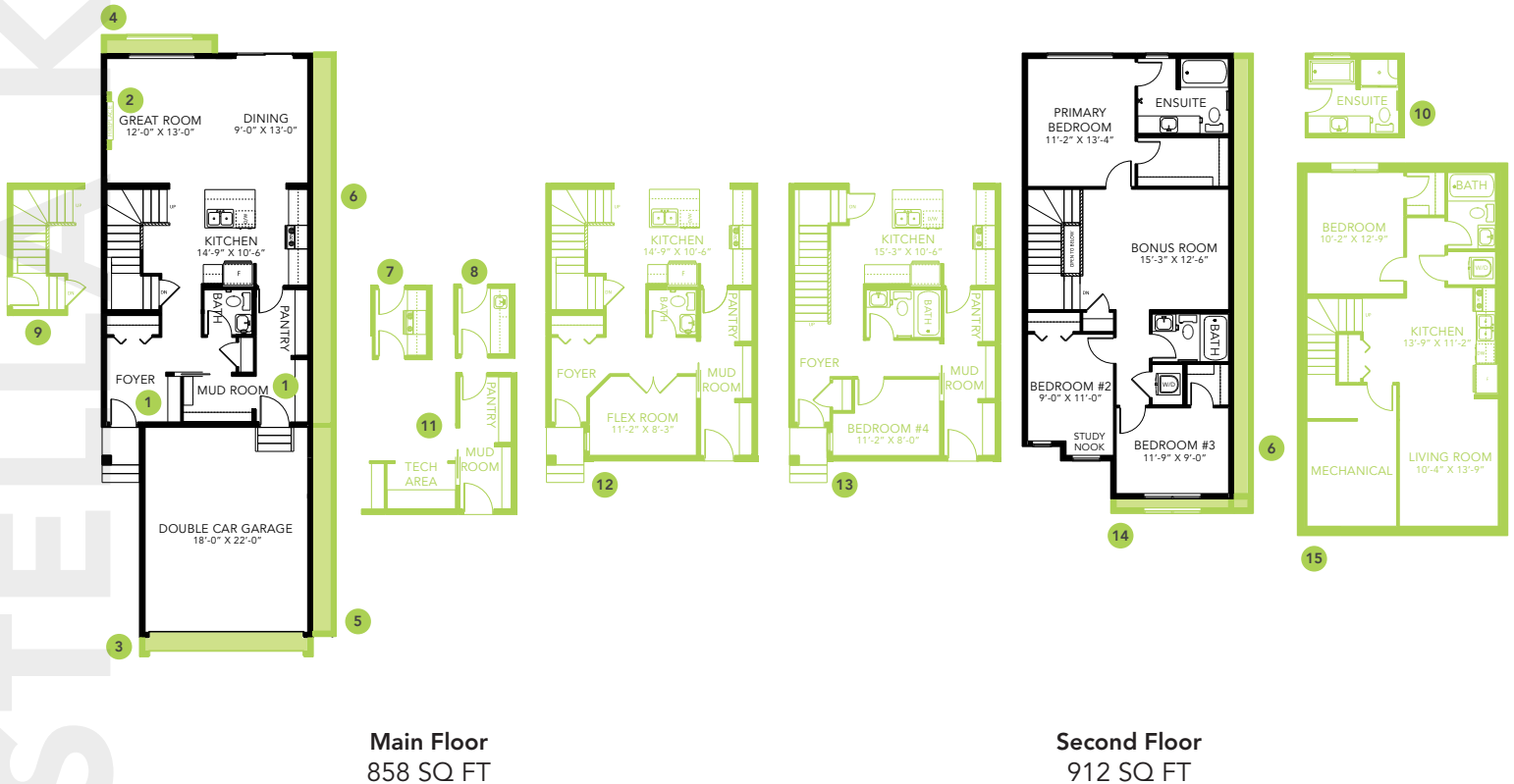

BUILT TO LAST \ BEDROCKHOMES.CA

SPEC 2022 - Bedrock Homes Ltd. reserves the right to modify floorplans, renderings, elevations and features in a continuing effort to improve product quality. Floorplans, specifications & prices are subject to change without notice. Errors & omissions exempt.