



BEDROCK
HOMES

STELLA B

1833 SQ FT
7119 182 Avenue NW



VITA AT CRYSTALLINA NERA SHOWHOME

18004 - 70th Street NW, Edmonton

587-570-5471

vitaatcrystallinanera@bedrockhomes.ca

Job # CSA 4979

Lot 6, Block 21, Plan na

DETAILS

- Double front attached garage home with 9' ceilings on the main floor, 4 bedrooms, bonus room and 3 full baths.
- Main Floor Bedroom and Full Bath Included for your short/long term visitors' convenience.
- Side Entrance included for a potential future Legal Suite, with the Basement Ceiling Height upgraded to 9' for a more spacious feel.
- Open floorplan in Great Room, Dining and Kitchen. Features elegant quartz throughout the home.
- Durable and stylish luxury vinyl plank flooring on the main floor, bathrooms and laundry room. Advanced wear and stain protection carpet with 35oz. Weight and 8lb underlay on the second floor.
- Modern, contemporary low maintenance kitchen featuring 41" upper cabinets to ceiling.
- Complete 6 piece appliance package. Included Stainless Steel Samsung Kitchen appliances and white front load washer and dryer.
- Upgraded spindle railing on the main floor offers optimal lighting and a spacious feel throughout.
- Triple pane Low E Argon gas filled Energy Star rated windows contributing to increased energy efficiency and outside noise reduction.
- Electric fire and ice linear fireplace in great room with timer & color control.
- Modern home technology package includes, Ecobee thermostat, Lorex video doorbell & Weiser Halo Wi-Fi Smart keyless lock with touch screen.
- Weather resistant precast concrete exterior steps that require no maintenance, and exterior walls and ceilings are vapour sealed.
- The ensuite in the primary bedroom features an upgraded large standing shower and dual sinks.

BUILT TO LAST \ \ [BEDROCKHOMES.CA](https://www.bedrockhomes.ca)

SPEC 2023 - Bedrock Homes Ltd. reserves the right to modify floorplans, renderings, elevations and features in a continuing effort to improve product quality. Floorplans, specifications & prices are subject to change without notice. Errors & omissions exempt.



BEDROCK
HOMES

STELLA B

1833 SQ FT
7119 182 Avenue NW



VITA AT CRYSTALLINA NERA SHOWHOME

18004 - 70th Street NW, Edmonton
587-570-5471
vitaatcrystallinanera@bedrockhomes.ca

Job # CSA 4979
Lot 6, Block 21, Plan na

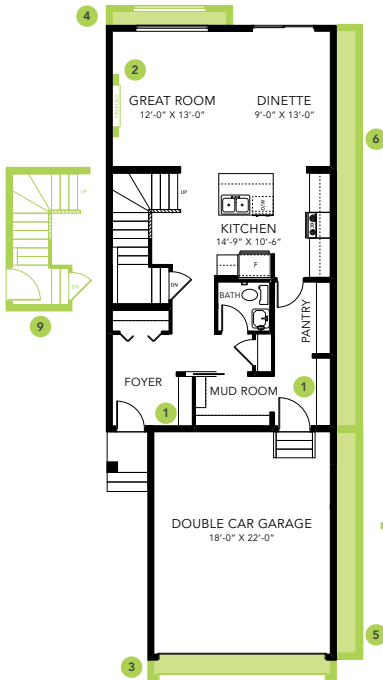

Main Floor
921 SQ FT



Second Floor
912 SQ FT

STELLA B