

Elena K at 22 Gambel Loop

| BED | BATH | SQ FT | HOME STYLE |
|-----|------|-------|----------------------------|
| 3 | 2.5 | 2088 | FRONT ATTACHED GARAGE HOME |

GARAGE TYPE

DOUBLE ATTACHED



AVAILABLE OCT. 2024

BLOCK: 7

STAGE: 3

LOT: 17

JOB: WST-0-035501

COMMUNITY



SHOWHOME ADDRESS 9 Gambel Loop

SHOWHOME HOURS Monday - Thursday
from 3 - 8PM
Weekend and
Holidays
from 12 - 5PM

CONTACT Mike Marsh
587.855.6551

Model Features

- This stunning home is located in an amenity rich community and within walking distance to Spruce Grove's new civic centre.
- This full walk-out home has an open-concept floorplan connecting the kitchen, dining area and the great room featuring electric fireplace.
- 10'x10' deck off the dining area offers views overlooking a serene pond - NO neighbors behind you!
- Modern kitchen features a huge island, cabinets to the ceiling and an included Samsung kitchen appliance package.
- A walk-in-closet and mudroom with built-in bench, shelf & hooks complete the main floor.
- Spindle railing on the stairs and upper hall connect the main floor to upper level and large central bonus room.
- The primary retreat, overlooking the pond, has a full walk-in-closet with an upgraded 5-piece ensuite, including a standalone soaker tub and tiled 5' shower.
- 9' foundation height perfect for future basement development.
- Trailblazer colour palette.
- Over \$94,000 in included designer options!

Floor Plans

MAIN FLOOR



SECOND FLOOR

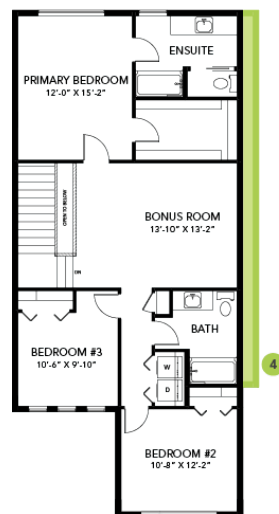

LEGAL BASEMENT SUITE

